

Observed snags as at 21 September:

ALL

Sprinkler heads – lots painted over – not likely able to diffuse mist

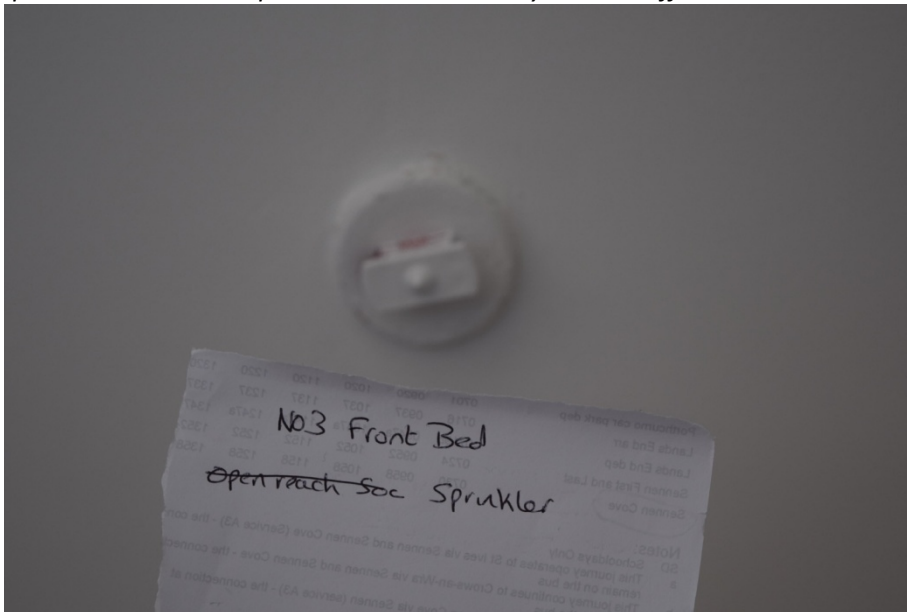

Bathroom doors – no locks

Windows & doors - all need to be tested for snagging / open / close / locking / keys



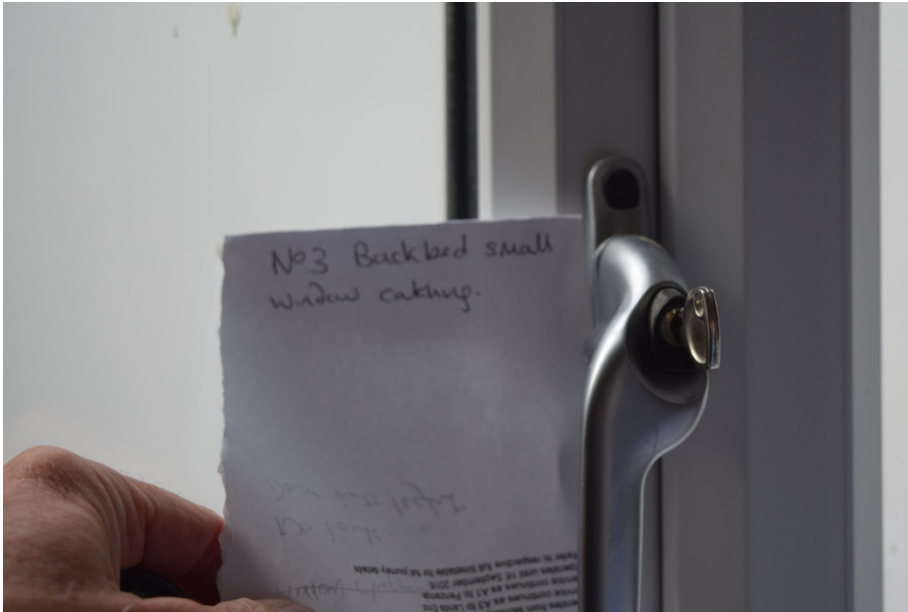

Sockets – numerous not fixed / surroundings require attention



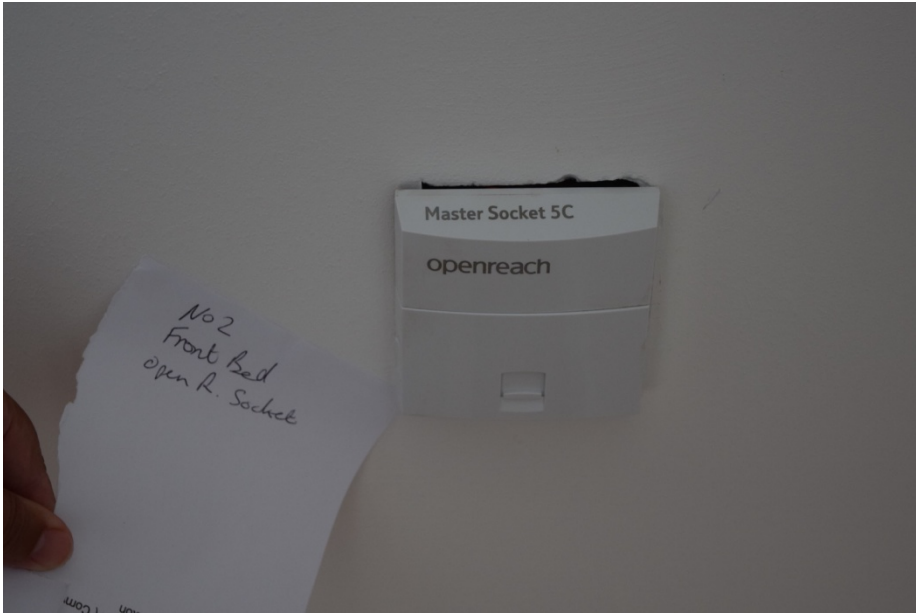

Pendant lights in hallways vs height of doors – risk of lamp strikes



Plumbing / heating schematics and instructions

A few floorboards proud – liable to snagging / damage

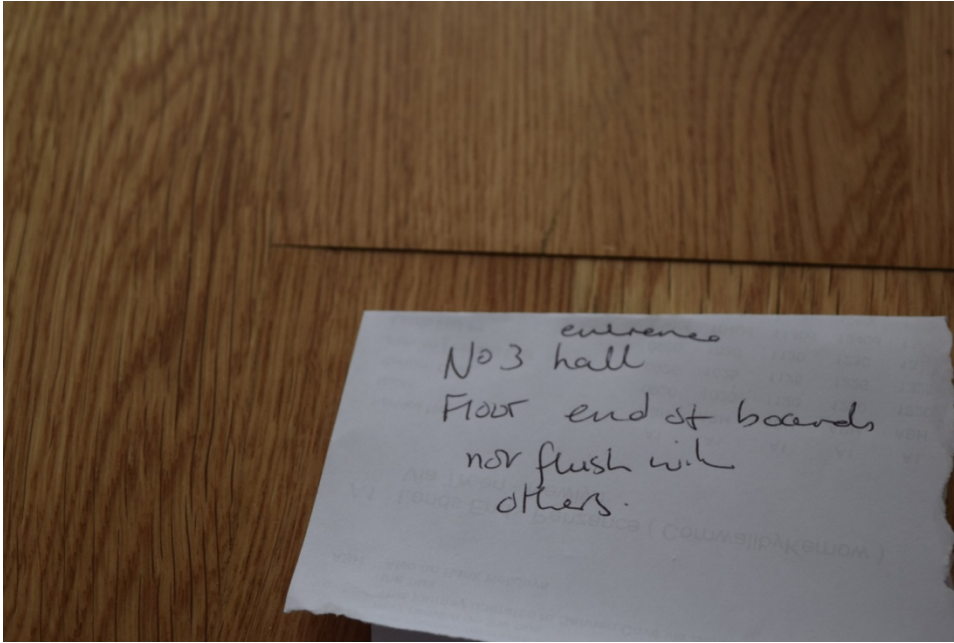

Misc paint splashes on floorboards and window furniture

#1:

Front door probably not open-able by disabled

Front bedroom door frame to wall – exposed foam

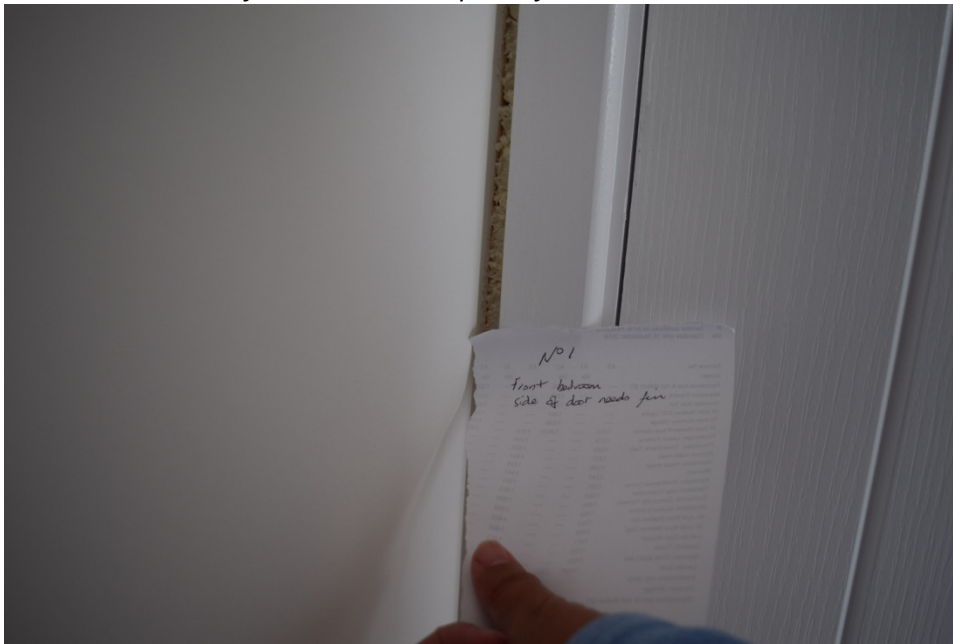

Low level understairs cupboard door needs finger hole / handle / latch

Big understairs cupboard door sticks

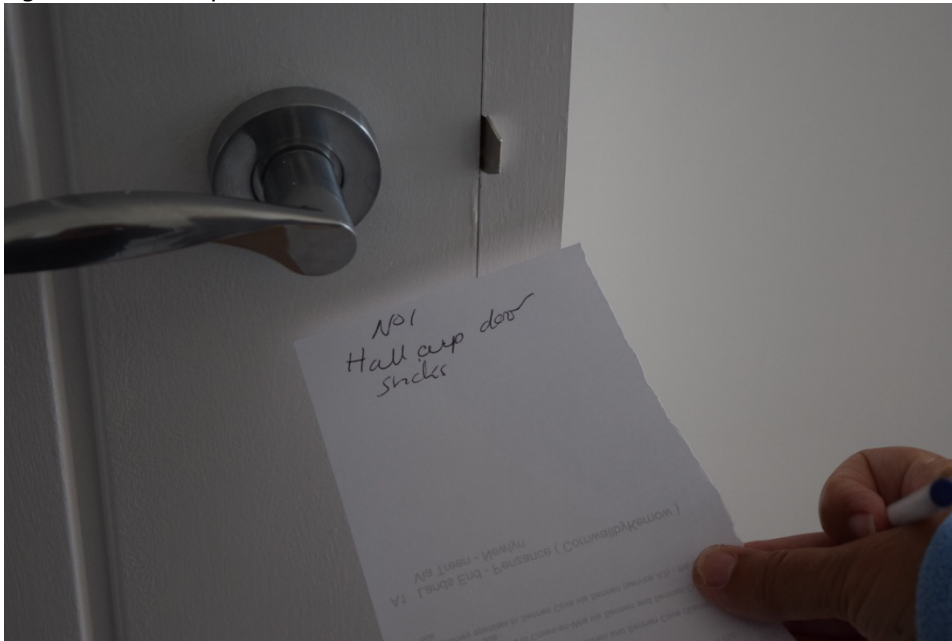

Shower room window – outside pane cracked

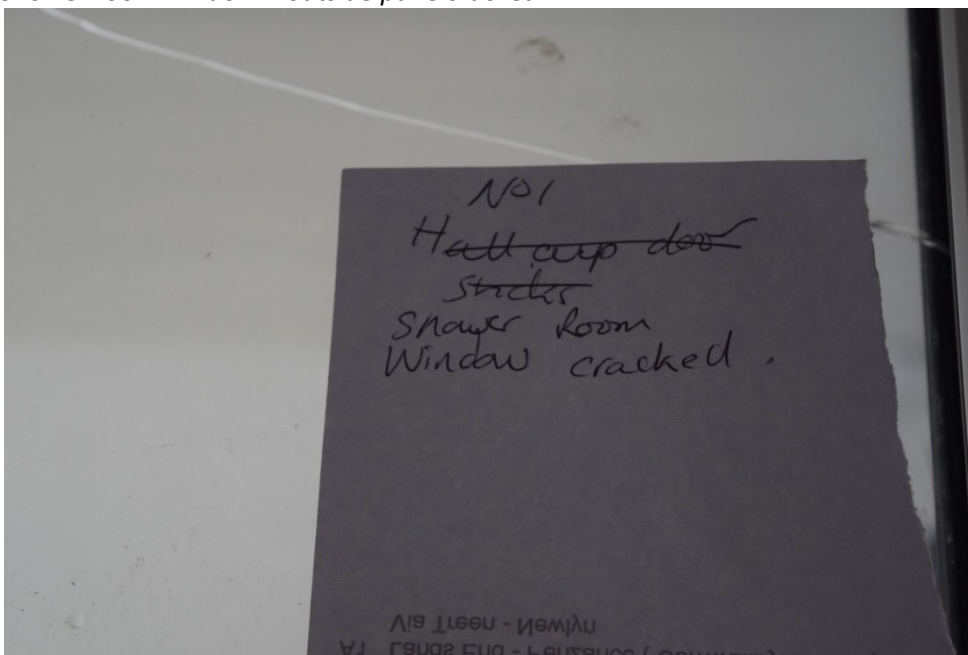

Shower room floor sealant not consistent all around

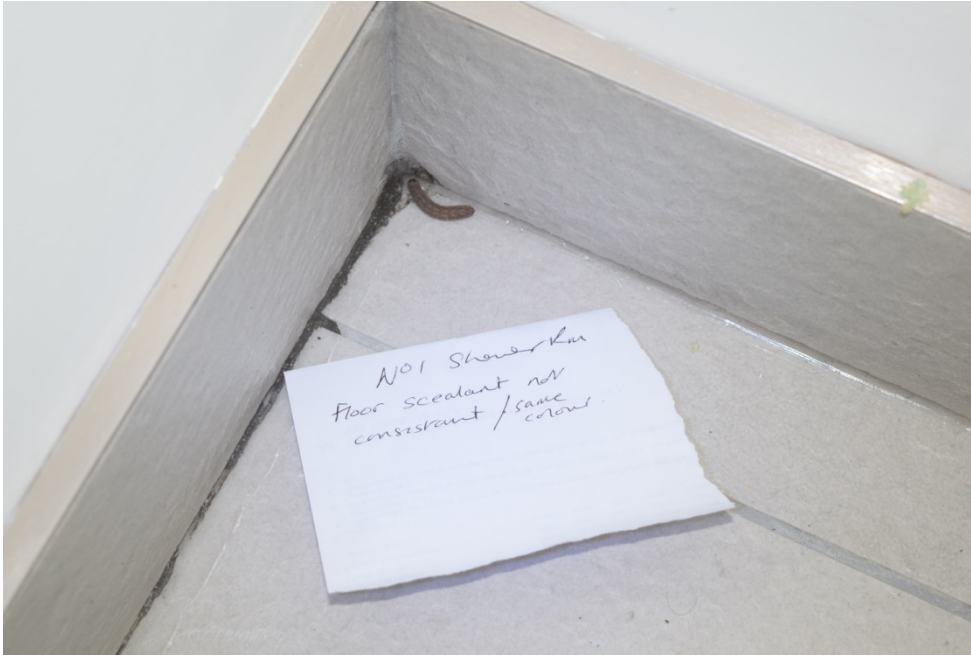

Shower room ceiling sealant not consistent all around



Shower room no mirror / fit at sensible height for sit & standing



Stable door does not open freely – catches on floor

Stable door – wood floor to door cill exposed – water ingress / damage likely



Upstairs French door cill not right & daylight showing under



Door on LHS (looking out) does not open to 90 degrees due to window cill



Upstairs cloakroom mirror does not match low level / disabled sink

Upstairs cloakroom cistern – blue flash



? washing machine

? shelves in kitchen cupboards

#3

Chipped bathroom mirror



Banister railing – #3

#2

Banister railing – def needed in #2

Heating / plumbing room cupboard ceiling

Bedroom cupboard door hinges missing screws



Understairs door missing screws

? washing machine

Oven to fit.

Outside

Water run-away under sprinkler tank

The mystery slate